



**Weyn-Lauwers** N.V.

Industriepark-Noord 12  
B - 9100 SINT-NIKLAAS

Tel. : 00 32 (0)3 776.34.13  
Fax : 00 32 (0)3 778.09.52  
weynlauwers@weynlauwers.be  
www.weynlauwers.be

**EXPANSION JOINT  
NBR  
FIG 971NBR**

**DESIGN FEATURES**

- expansion joint dn32 - dn200 PN10
- NBR bellow
- temp : -10°C +80°C
- specifications :
  - absorbs vibrations and noises
  - linear and angular compansion
  - single sphere

**USE**

- for oil, hydrocarbon, air
- max. pressure : up to 10 bar

**MATERIALS**

item	Part name	Material
1	bellow	NBR
2	reinforcement	nylon cord
3	brace	hard steel
4	flanges	galvanized steel

**SIZE (in mm)**

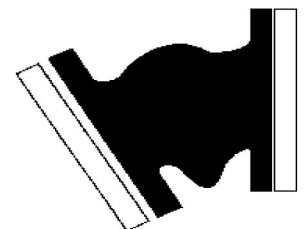
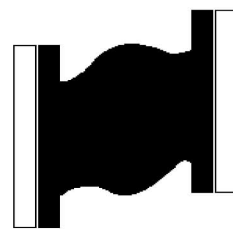
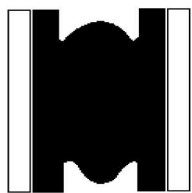
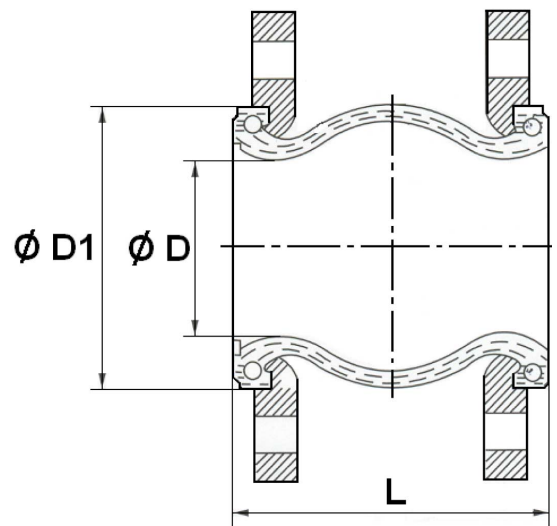
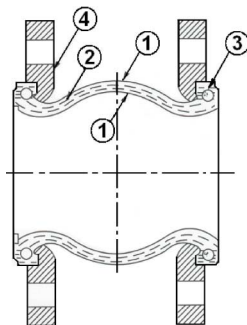

Compansion

Expansion

Lateral

Angular

DN	32	40	50	65	80	100	125	150	200		
L	95	95	105	115	130	135	170	180	205		
D	40	40	52	68	76	103	128	152	194		
D1	69	69	85	106	116	150	180	209	260		
compansion	8	8	8	12	12	18	18	18	25		
expansion	4	4	5	6	6	10	10	10	14		
lateral	8	8	8	10	10	12	12	12	22		
angular	15'	15'	15'	15'	15'	15'	15'	15'	15'		
kg	2,79	3,29	4,23	4,74	6,27	6,47	9,4	12,75	17,73		
ref.	971NBR07	971NBR08	971NBR09	971NBR10	971NBR11	971NBR12	971NBR13	971NBR14	971NBR16		