



Weyn-Lauwers N.V.

INDUSTRIEPARK-NOORD 12
B - 9100 SINT-NIKLAAS

TEL. 0032 (0)3 776.34.13
FAX. 0032 (0)3 778.09.52

weynlauwers@weynlauwers.be
www.weynlauwers.be

BALL VALVE "TOTAL" BRASS - HEAVY DUTY up to PN100 - fig 120

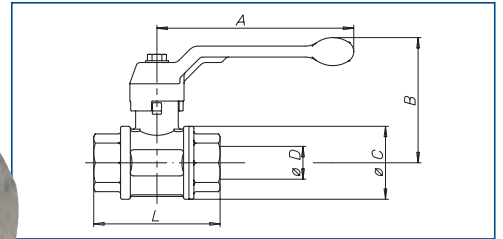
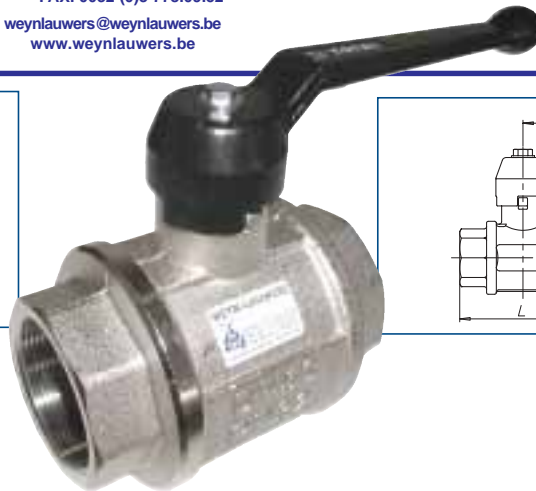
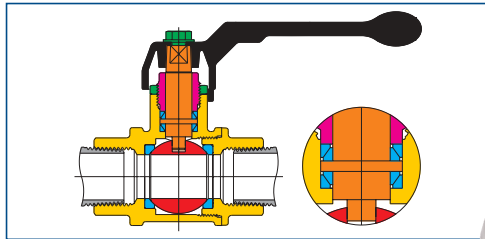

TECHNICAL FEATURES:

Temperature limits: for fluids from -20°C to +130°C (peak temperature +150°C)
for gas from -20°C to +60°C

Pressure limits: for fluids from 100 bar to 40 bar
for gas MOP5

Application fields:

TOTAL series is used in presence of special performance requirements, for example in the installations of: gas and water distribution, industrial and civil heating, water plants at medium and high pressure, hydraulics, oil and petrochemical fields, non aggressive media, steam and vacuum. On request available in degreased version.

Threaded end connections:

- Standard female and male according to ISO 7/1
- On request NPT or BSPT

Operation devices:

aluminium lever and T-handle, square cap, underground adaptor, sealing cap.
Available colours: black, red, green, blue, yellow

SPECIFIC FEATURES:

- the TOTAL valve, with full bore, is an extremely robust product
- with perfect air bubble sealing
- does not need any maintenance, is equipped with wrapping seats ensuring long life cycles
- four self-adjusting cone-shaped seals, with PTFE-PTFE sliding, therefore without wear, form two sealings with automatic functioning
- an adjusting gland allows the sealing reset on the stem
- all valves are tested according to a strict procedure covering severe inspections on the entire production
- the valve is approved according to DIN-DVGW standards: such approval was obtained for the first time in 1974 and then always renewed up to the present one.
- tested for vacuum at 1×10^{-2} mbar
- on request the valve is available with ATEX certificate

LIST OF COMPONENTS: description/materials/treatments

Component	Description	Material	Treatment	UNI EN
body and threaded end	yellow	hot stamped from bar	CW617N	UNI EN 12165
gland	violet	machined from bar	CW614N	UNI EN 12164
gland nut	green	machined from bar	CW614N	UNI EN 12164
stem	orange	machined from bar	CW617N	UNI EN 12164
chromium pl. polished ball	red	machined from bar	CW617N	UNI EN 12164
seals	blue	virgin PTFE		
operation device	black	die-cast alumin. alloy polyur c.		UNI 5076
fixing screw	green	zinc plated steel		
surface treatment	—	brilliant nickel-plating		

GENERAL TABLE: valve dimensions per type and size

nominal diameter	6	8	10	15	20	25	32	40	50	65	80
gas size in inch	1/8"	1/4"	3/8"	1/2"	3/4"	1"	1 1/4"	1 1/2"	2"	2 1/2"	3"
Ø D bore mm	8	8	10	15	20	25	32	40	50	65	80
A mm	75	75	100	100	120	120	150	150	175	280	280
B mm	52	52	61	64	76	80	98	104	119	155	167
Ø C mm	23	23	29	36	45	54	65	79	96	119	144
female L mm	50	51	55	69	77	89	103	114	134	160	185
female weight gr	160	150	245	370	635	890	1555	2315	3630	5540	8440

PRESSURE/TEMPERATURE DIAGRAM

at each pressure level corresponds a specific admissible temperature level and viceversa

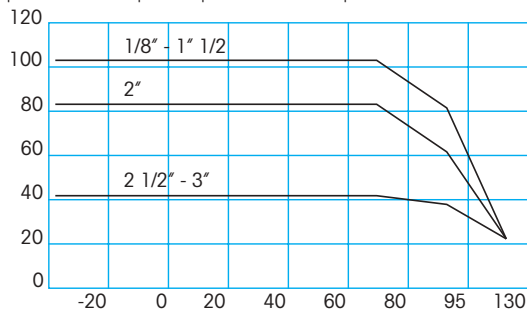

LOSS OF HEAD DIAGRAM:

the Kv value is the port capacity causing a pressure drop of 1 bar.

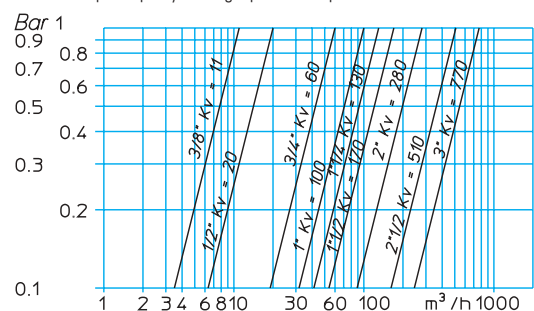

ORDER REFERENCE

1/8"	205201	3/8"	205203	3/4"	205205	5/4"	205207	2"	205209	3"	205211
1/4"	205202	1/2"	205204	1"	205206	6/4"	205208	2 1/2"	205210		